

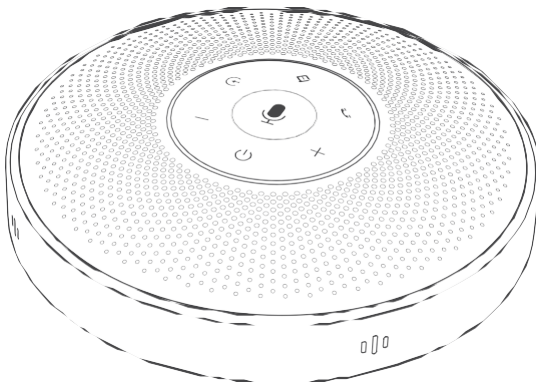

eMeet OfficeCore M2

User Manual







Wireless Speakerphone

無線ハンズフリー電話 | 智能会议宝

Drahtlose Freisprecheinrichtung | Telefono vivavoce wireless

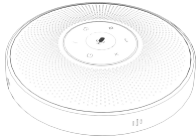
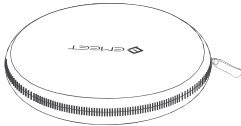
Altavoz inalámbrico | Téléphone mains libres sans fil



			
x1		x1	
			
x1	x1	x1	x1

English

Product description

eMeet O ceCore M2 Lite products is small portable omnidirectional speakerphone with high-quality connection for far-field, 360-degree sound pick-up. Connection of eMeet O ceCore M2 Lite products to PC, phone or tablet PC via Bluetooth, USB or AUX (analog audio) is available.

Function display

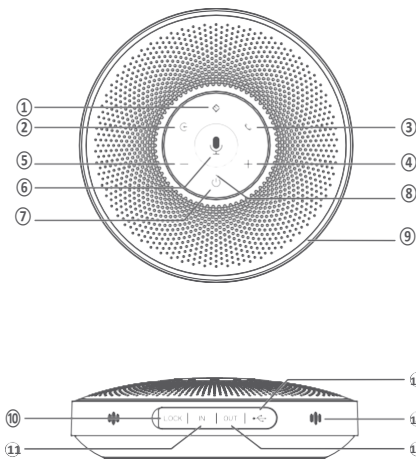

- ① AI noise reduction on/o button
- ② Bluetooth button
- ③ Answer/end Call
- ④ Volume up
- ⑤ Volume down
- ⑥ Mic Mute/Unmute
- ⑦ On/o
- ⑧ Status light
- ⑨ Ring-shaped light

- ⑩ Lock
- ⑪ AUX audio input port
- ⑫ Earphone audio output port/
Daisy chain port
- ⑬ USB port
- ⑭ Microphone

How to use

1. On/o



Press On/O “  ” for 2 seconds to turn on or o .

2. Four operating modes

2.1 The first mode: connect the computer to eMeet O ceCore M2 Lite product with a USB cable

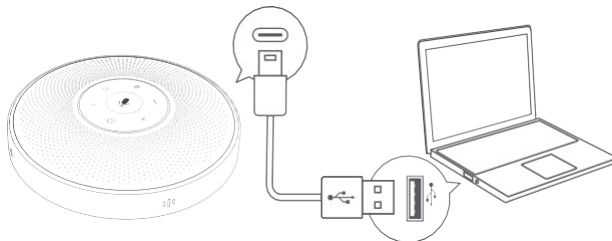

2.2 The second mode: connect eMeet O ceCore M2 Lite product via Bluetooth



- ① Press the “  ” for two seconds. The status light is blue when pairing
- ② Turn on Bluetooth on mobile phone or PC and select eMeet M2 Lite from the list of devices

2.3 The third mode: connect eMeet O ceCore M2 Lite product via eMeet Audio adapter A200

- ① Plug eMeet Audio adapter A200 into computer, turn on eMeet O ceCore M2 Lite product and press the “  ” for two seconds. The status light is blue and enter pairing.
- ② The eMeet Audio adapter A200 will be automatically connected to eMeet O ceCore M2 Lite product.

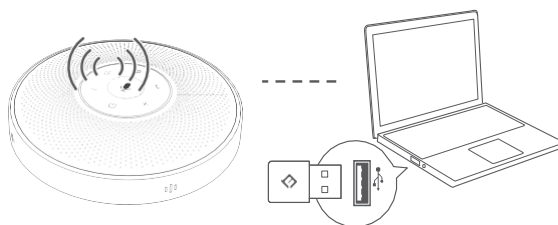

2.4 The fourth mode: connect eMeet O ceCore M2 Lite product with AUX analog audio wire

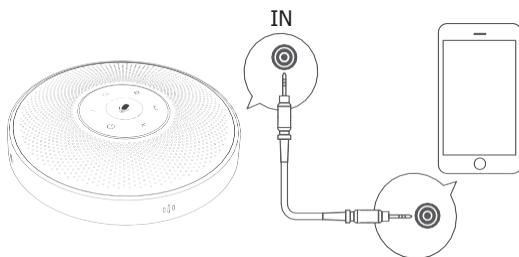

3. Daisy chain function

The Daisy chain function requires the use of Daisy chain cable, which are inserted into the OUT port (circles) of the two machines using Daisy chain cable to extend the distance of sound pickup and playback so as to get a larger meeting space.

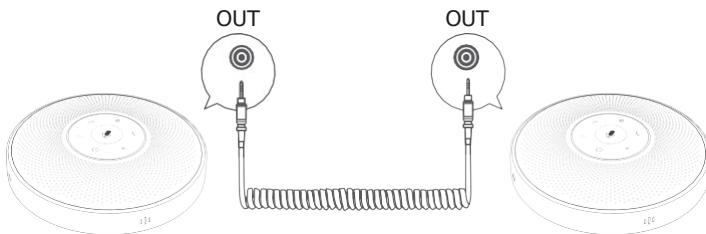

Note : 1)Daisy chain function, “ · ” Status light is Ice Blue light.
2)Daisy chain needs to be purchased separately.

4. Answer\end call



4.1 When there is an incoming call, press the “ 📞 ” button to answer the call.

4.2 In the talk mode, press the “ 📞 ” button to end the call.

Note:

① After the device is connected to a mobile phone via Bluetooth, you can answer and hang up calls with eMeet O ceCore M2 Lite(Remark:Some softphones do not support this function).

② After the device is connected to a PC through the USB cable, you can answer and hang up Skype for Business calls.

5. AI noise reduction on/o button



Short press the “” button to turn on/o VoicelA noise reduction mode. With VoicelA noise reduction can shield some common noises that may occur in conference scenes, such as keyboard taps, air conditioning noises, and the sound of moving chairs and tables. Please be attention that the voice pick-up range might be shortened when the noise reduction mode is on. Therefore, to maintain a good voice pick-up effect, please make your call within 1.5 meter away from the device.

Also, the DOA position indicating light will be displayed in green while the noise reduction mode is on, and will change to in blue when the noise reduction mode is o .

6. Control volume



Press the volume “+”, volume “-” to increase or decrease the volume.

7. Mic Mute/Unmute



When the mic is open, pressing “” will mute the mic.

When the mic is muted, pressing “” will unmute the mic.

8. Check Battery level



Short press “” to check Battery level.

When the device reaches 5% battery level, the ring-shaped indicator will glow red, and a low battery prompt will be generated.



5%



25%



50%



75%



100%

9. Charge eMeet O ceCore M2 Lite product

9.1 Via the computer

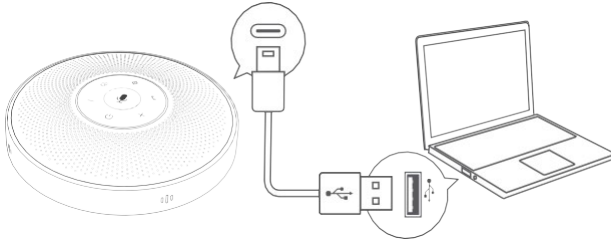

9.2 Through the adapter

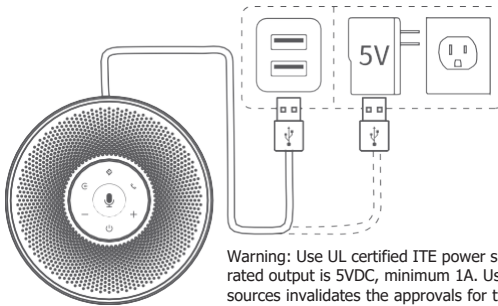

Warning: Use UL certified ITE power supply only, the rated output is 5VDC, minimum 1A. Using other power sources invalidates the approvals for this device and triggers potential danger.

10. External speaker

Connect the speaker to the AUX OUT port of eMeet O ceCore M2 Lite product with audio wire.

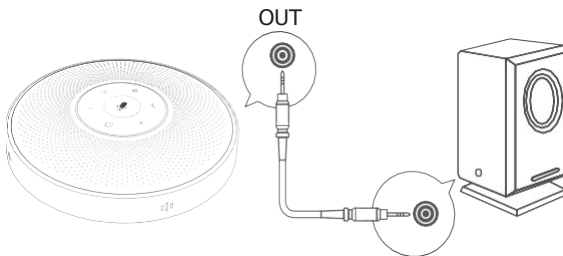

For more information, please visit www.emeeet.ai/support

Notes

- ① Do not place the battery in direct sunlight or fire exposure places.
- ② Note: If the battery or battery pack is improperly replaced, there will be explosion hazard. Only technical engineers of our company or our authorized service points can replace with battery of the same or equivalent type.
- ③ The whole device and accessories should be placed in dry ventilated indoor places to avoid rain, water drop, water ingress, fall and coverage of vent holes.
- ④ To protect the environment, put the discarded products into the designated sorting trash bin and do not discard directly.
- ⑤ M2 temperate zone. M2 works best from 0° to 35°C(32°to 95°F). You should store it in environments of -20° to 45°C(-4°to 113°F).As near room temperature as possible 22°C (72°F).



Only applicable to areas of an altitude below 2000m



Only applicable to non-tropical climate



Bluetooth

The Bluetooth® words and trademarks are reserved by Bluetooth SIG, Inc.

Product information

Speaker output rating	3W RMS
Frequency response	20Hz~20KHz(±1dB)
SNR	> 80dB
Bluetooth version	V4.2
Bluetooth distance	5 m
Microphone sensitivity	-26dBFS
Microphone frequency response	100Hz~8KHz
Microphone directivity	360 degree omnidirectional
Battery specification	3.6V/2600mAh
Charge time	3-4hours
Usage time	Talk time: 12 hours (Depending on the usage, the talk time varies)
Charge specification	5V/1A

Size	125x125x35mm
Weight	300g

FAQ

Problem or phenomenon	Possible Causes	Method
Startup failure	Low or no battery	Access the adapter to charge
Automatic shutdown soon after starting up	Low battery	Access the adapter to charge
No sound	Check the correct connection; turn on the volume	Adjust the device volume
USB failure	Error with using USB cable	Please use the original USB cable
AUX failure	Error with using AUX cable	Please use the original AUX cable
Daisy chain failure	Plug in the AUX audio input port; Error with using Daisy chain cable	Please plug the original Daisy chain cable into the Earphone audio output port/Daisy chain port
Device charge failure	Faulty charging device or full battery	Replace with a functional device

Warranty

Limited one (1) Year Warranty with proof of purchase. Exempt from warranty are limited-life consumable components subject to normal wear and tear, e.g. batteries and other accessories.

Contact us

For all customer service and technical support
 Email: Support@eMeet.ai Website: www.eMeet.ai

FCC

This equipment has been tested and found to comply with the limits for a Class B digital device, pursuant to Part 15 of the FCC Rules.

These limits are designed to provide reasonable protection against harmful interference in a residential installation. This equipment generates uses and can radiate radio frequency energy and, if not installed and used in accordance with the instructions, may cause harmful interference to radio communications. However, there is no guarantee that interference will not occur in a particular installation. If this equipment does cause harmful interference to radio or television reception, which can be determined by turning the equipment off and on, the user is encouraged to try to correct the interference by one or more of the following measures:

- Reorient or relocate the receiving antenna.
- Increase the separation between the equipment and receiver.
- Connect the equipment into an outlet on a circuit different from that to which the receiver is connected.
- Consult the dealer or an experienced radio/TV technician for help.

Changes or modifications not expressly approved by the party responsible for compliance could void the user's authority to operate the equipment.

This device complies with part 15 of the FCC Rules. Operation is subject to the following two conditions: (1) This device may not cause harmful interference, and (2) This device must accept any interference received, including interference that may cause undesired operation.

IC

This device complies with Industry Canada's licence-exempt RSSs. Operation is subject to the following two conditions:

- (1) This device may not cause interference; and
- (2) This device must accept any interference, including interference that may cause undesired operation of the device.

Le présent appareil est conforme aux CNR d'Industrie Canada applicables aux appareils radio exempts de licence. L'exploitation est autorisée aux deux conditions suivantes : (1) l'appareil ne doit pas produire de brouillage, et (2) l'utilisateur de l'appareil doit accepter tout brouillage radioélectrique subi, même si le brouillage est susceptible d'en compromettre le fonctionnement.